



BNC Series 50 ohms / 75 ohms connectors are small, bayonet lock coaxial RF connector which are most widely used. The bayonet lock provides quick connect disconnect coupling.

The Sricom range of BNC Connectors cover different cable and chasis mounting styles; in addition, connectors with special cable entry features and variations in mounting styles could be supplied against specific requirements.

Sricom BNC Connectors are manufactured to ensure conformity to joint service specifications J 52401 in terms of Electrical performance and mating face requirements. They are fully intermatable with connectors manufactured to meet US specifications MIL – C 39012.

BNC Connectors are available in both 50 and 75 ohms impedance; BNC 50 ohms and 75 ohms connectors are intermatable.

MATERIAL

Body & Body Components	Extruded Brass
Centre Contact Male	Extruded Brass
Centre Contact Female	Beryllium Copper
Dielectric	PTFE
Clamp Gaskets	Silicone Rubber
Crimp Ferrule	Annealed Copper

MECHANICAL

Mating	2 stud bayonet lock coupling
Cable Affixment	Clamp Screw-thread nut and braid clamp
Cable Retention	Clamp : 178 N minimum Crimp : 400.5 N minimum

TECHNICAL SPECIFICATIONS

ELECTRICAL

Impedance	50 / 75 ohms
Frequency Range	0 – 4 GHz
Voltage Rating	500 V Peak
Insulation Resistance	5000 Meg Ohms (Min)
Centre Contact Resistance	1.5 Milli ohms (Max)
Outer Contact	0.2 Milli ohms
Braid to Body	0.1 Milli ohms
Insertion Loss	0.2 dB maximum at 4 GHz
Dielectric Withstanding	1500 Volts RMS at Sea level
VSWR	1.3 : 1 Max at GHz for 50Ω

ENVIRONMENTAL

Impedance	50 / 75 ohms
Temp. Range	- 65° C to + 85° C
	JSS 50101
Shock	JSS 50101 – Test No. 12 MIL Std – 202 Method 204 (Test Cond. D)
Temp. Cycling	JSS 50101 – Test No. 20 MIL Std – 202 Method 102 (Test Cond. D)

FINISH

Body	Silver / Nickel
Centre Contacts	Gold



Interface Dimensions – BNC Series

PLUG

JACK

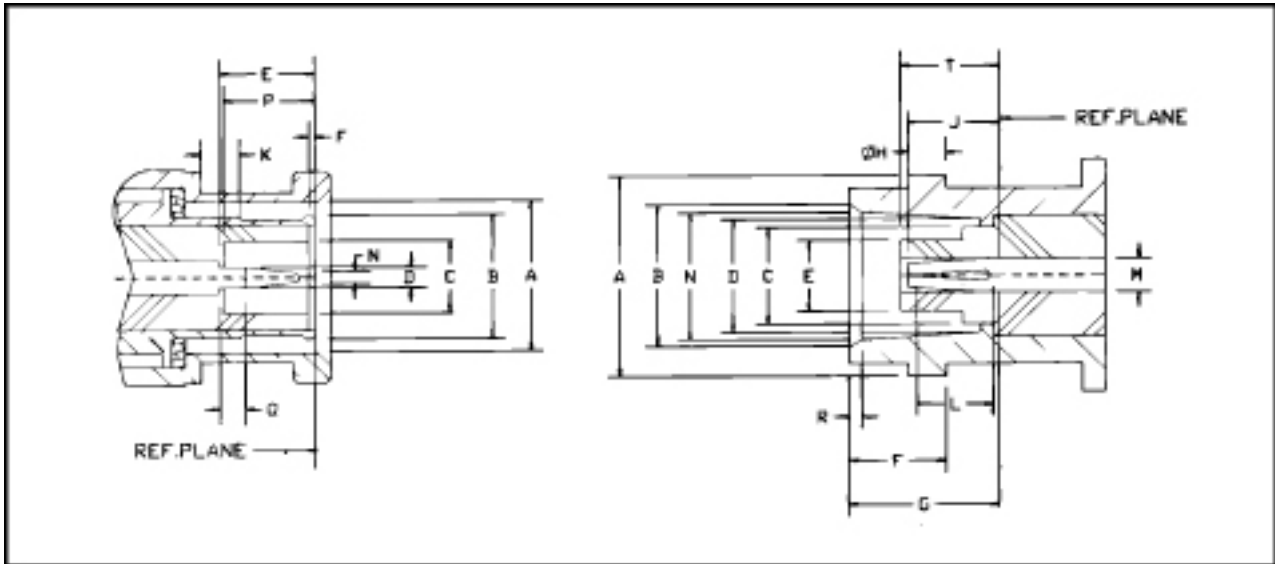

LTR (dim. of)	PLUG		JACK	
	MIN	MAX	MIN	MAX
A	9.78	9.91	10.97	11.07
B	Note 1		9.60	9.70
C	4.83	–	–	6.50
D	1.32	1.37	8.10	8.15
E	5.33	5.84	–	4.72
F	0.15	–	5.18	5.28
G	–	–	8.31	8.51
H	–	–	1.91	2.06
J	–	–	4.72	5.23
K	2.31	2.46	–	–
L	–	–	4.95	–
M	–	–	2.06	2.21
N	–	0.64	8.79	9.04
P	5.28	5.79	–	–
Q	1.98	–	–	–
R	–	–	0.38	0.76
T	–	–	4.78	5.28

Note 1 : Diameter to meet gauge test requirements

ALL DIMENSIONS ARE IN MM

**B
N
C**



CONTENTS

SEARCH

PREVIOUS

NEXT

B
N
C

**Straight Plugs
Clamp Type**

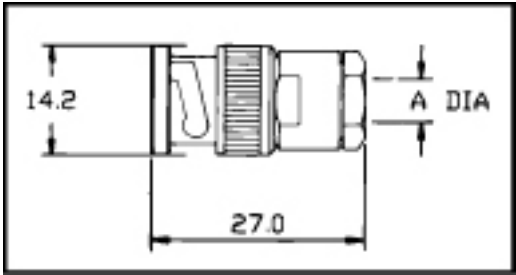

Order Code	US-MIL No	Impedance Ohms	Cable Group RG/U	Note	A Dia (Max)
SC2 M 01	UG 88 / U	50	55, 58, 141, 142 223, 303, 400	Captive Contact	5.6
SC2 M 02	UG 260 / U	75	59, 302	Captive Contact	6.2
SC2 M 12		93	62, 210, 71	Captive Contact	6.6
SC2 M 07		50	174, 188, 316	Captive Contact	2.9
SC2 M 17		75	179, 187	Captive Contact	2.9

For Cable Assembly Refer Fig. B 01

**Straight Plugs
Crimp Type**

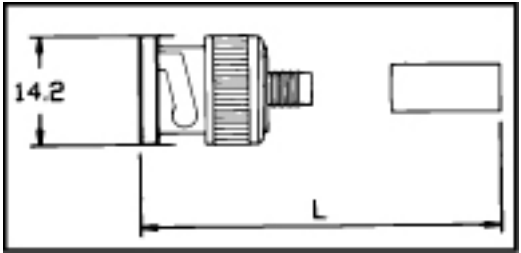

Order Code	US-MIL No	Impedance Ohms	Cable Group RG/U	L Dimn (Max)
SC2 M 03	UG 1786 / U	50	55, 58, 141, 142 223, 303, 400	30.3
SC2 M 05		75	59, 302	28.8
SC2 M 25		93	62, 210, 71	28.8

For Cable Assembly Refer Fig. B 02



CONTENTS

SEARCH

PREVIOUS

NEXT

**Right Angle Plugs
Clamp Types**

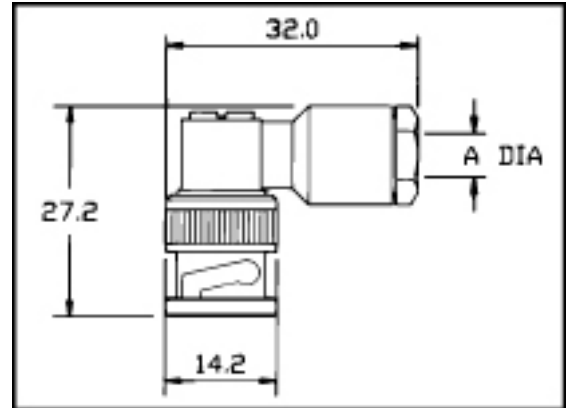

**B
N
C**

Order Code	US-MIL No	Impedance Ohms	Cable Group RG/U	Note	A Dia (Max)
SC2 A 01	UG 913 / U	50	55, 58, 141, 142 223, 303, 400	Captive Contact	5.6
SC2 A 02		75	59, 302	Captive Contact	6.2
SC2 A 12		93	62, 210, 71	Captive Contact	6.6
SC2 A 07		50	174, 188, 316	Captive Contact	2.9
SC2 A 17		75	179, 187	Captive Contact	2.9

For Cable Assembly Refer Fig. B 03

**Right Angle Plugs
Clamp Types**

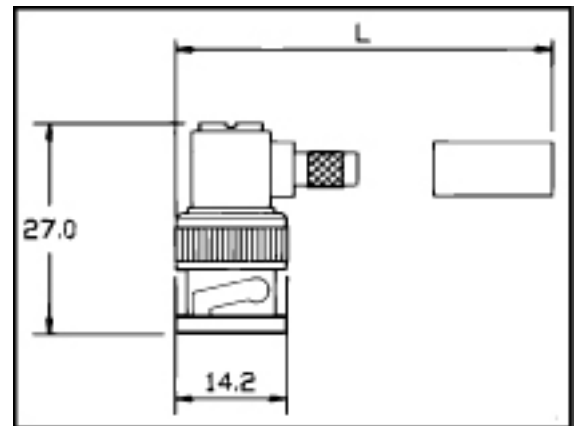

Order Code	Impedance Ohms	Cable Group RG/U	L Dimn (Max)
SC2 A 03	50	55, 58, 141, 142 223, 303, 400	28.7
SC2 A 05	75	59, 302	26.2
SC2 A 25	93	62, 210, 71	26.2
SC2 A 09	50	174, 188, 316	24.7
SC2 A 19	75	179, 187	24.7

For Cable Assembly Refer Fig. B 02



CONTENTS

SEARCH

PREVIOUS

NEXT

**Straight Jacks
Clamp Type**

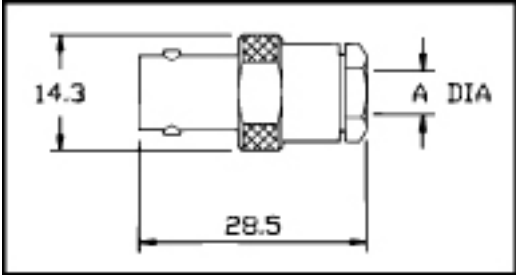

B
N
C

Order Code	US-MIL No	Impedance Ohms	Cable Group RG/U	Note	A Dia (Max)
SC2 SR 01	UG 98 / U	50	55, 58, 141, 142 223, 303, 400	Captive Contact	5.6
SC2 SR 02	UG 261 / U	75	59, 302	Captive Contact	6.2
SC2 SR 12		93	62, 210, 71	Captive Contact	6.6
SC2 SR 07		50	174, 188, 316	Captive Contact	2.9
SC2 SR 17		75	179, 187	Captive Contact	2.9

For Cable Assembly Refer Fig. B 01

**Straight Jacks
Crimp Type**

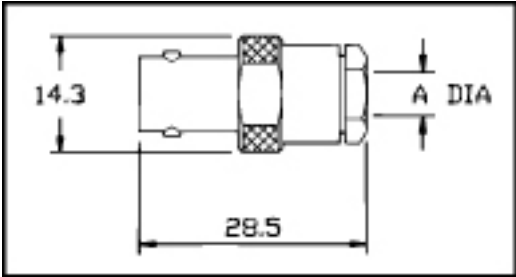

Order Code	Impedance Ohms	Cable Group RG/U	L Dimn (Max)
SC2 SR 03	50	55, 58, 141, 142 223, 303, 400	32.5
SC2 SR 05	75	59, 302	31
SC2 SR 25	93	62, 210, 71	31

For Cable Assembly Refer Fig. B 02



**Panel Jacks
Clamp Type**

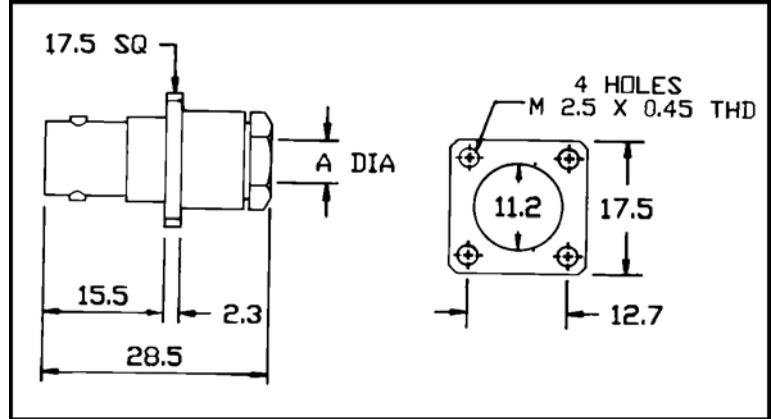

B
N
C

Order Code	US-MIL No	Impedance Ohms	Cable Group RG/U	Note	A Dia (Max)
SC2 PR 01	UG 291 / U	50	55, 58, 141, 142 223, 303, 400	Captive Contact	5.6
SC2 PR 02	UG 262 / U	75	59, 302	Captive Contact	6.2
SC2 PR 12		93	62, 210, 71	Captive Contact	6.6
SC2 PR 07		50	174, 188, 316	Captive Contact	2.9
SC2 PR 17		75	179, 187	Captive Contact	2.9

For Cable Assembly Refer Fig. B 01

**Panel Jacks
Crimp Type**

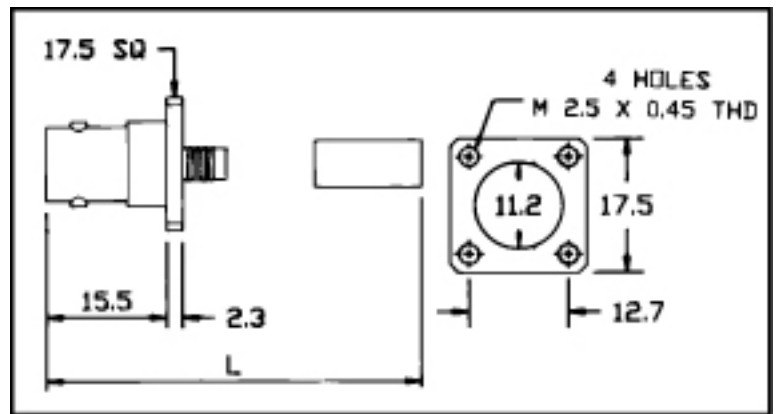

Order Code	Impedance Ohms	Cable Group RG/U	L Dimn (Max)
SC2 PR 03	50	55, 58, 141, 142 223, 303, 400	32.5
SC2 PR 05	75	59, 302	31
SC2 PR 25	93	62, 210, 71	31

For Cable Assembly Refer Fig. B 02



CONTENTS

SEARCH

PREVIOUS

NEXT

B
N
C

**Bulk Head Jacks
Clamp Type**

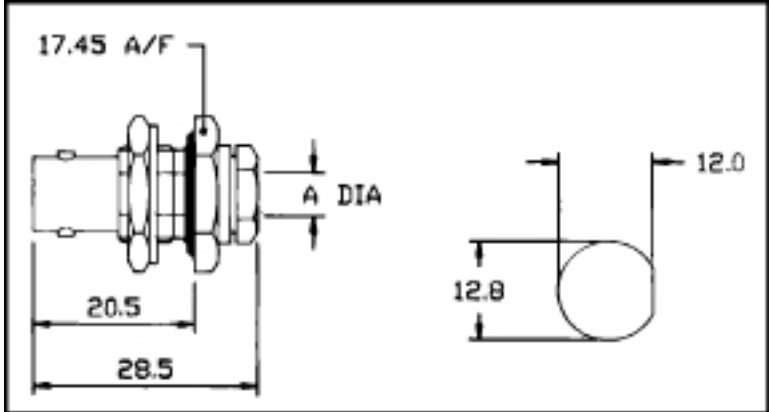

Order Code	Impedance Ohms	Cable Group RG/U	Note	A Dia (Max)
SC2 BR 01	50	55, 58, 141, 142 223, 303, 400	Captive Contact	5.6
SC2 BR 02	75	59, 302	Captive Contact	6.2
SC2 BR 12	93	62, 210, 71	Captive Contact	6.6
SC2 BR 07	50	174, 188, 316	Captive Contact	2.9
SC2 BR 17	75	179, 187	Captive Contact	2.9

For Cable Assembly Refer Fig. B 01

**Bulk Head Jacks
Crimp Type**

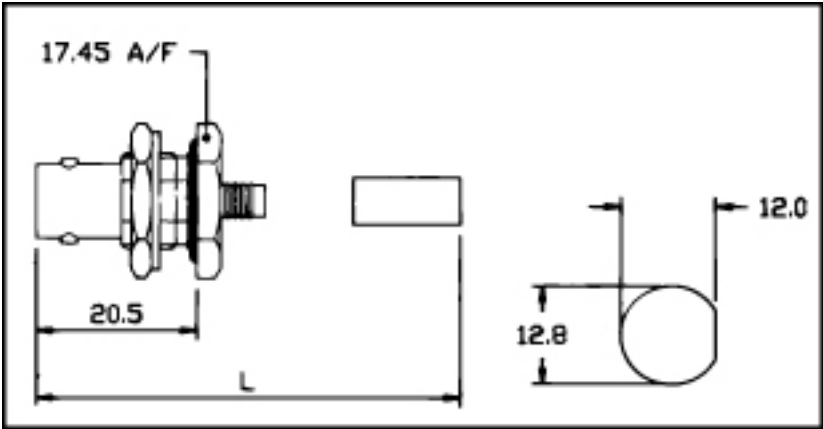

Order Code	Impedance Ohms	Cable Group RG/U	L Dimn (Max)
SC2 BR 03	50	55, 58, 141, 142 223, 303, 400	32.5
SC2 BR 05	75	59, 302	31
SC2 BR 25	93	62, 210, 71	31

For Cable Assembly Refer Fig. B 02



CONTENTS

SEARCH

PREVIOUS

NEXT

Bulk Head Receptacle-Plug

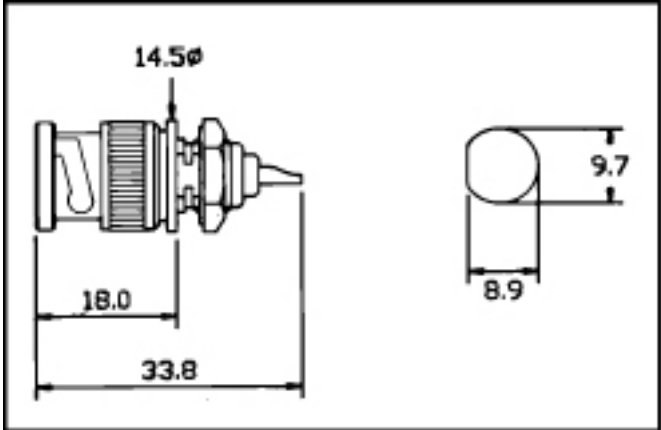

B
N
C

Order Code	Impedance Ohms
SC2 BM 01	50
SC2 BM 02	75

Bulk Head Receptacle

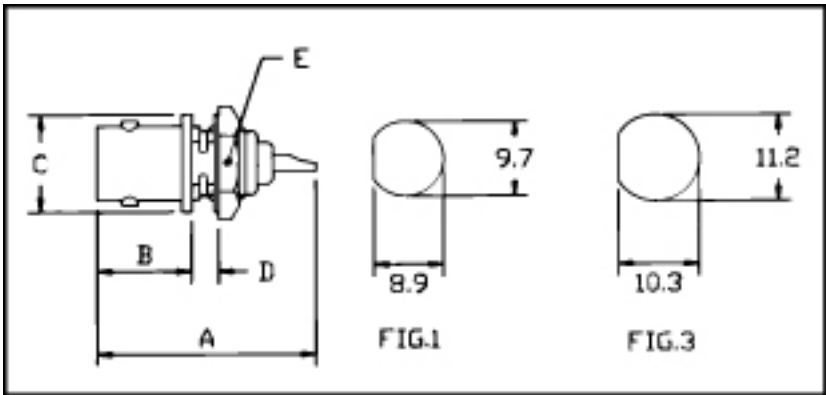

Order Code	US-MIL No.	Impedance Ohms	Dimensions (Max)					For Panel Piercing
			A	B	C	D	E	
SC2 F 01	UG 1094 / U	50	27.0	12.0	12.7	3.2	12.7	Fig. 1
SC2 F 01 - 75		75	27.0	12.0	12.7	3.2	12.7	Fig. 1
SC2 F 06		50	27.0	12.0	12.7	3.2	14.2	Fig. 3



CONTENTS

SEARCH

PREVIOUS

NEXT

**Bulk Head
Receptacle**

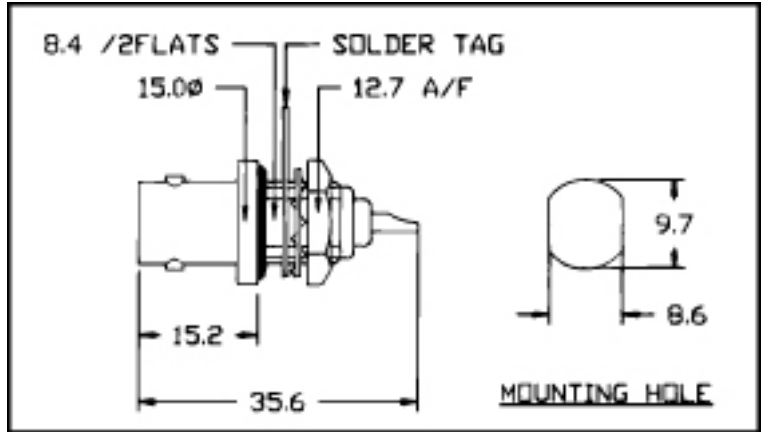

Order Code	US-MIL No.	Impedance Ohms
SC2 F 03	UG 657/U	50

**Bulk Head
Receptacle**

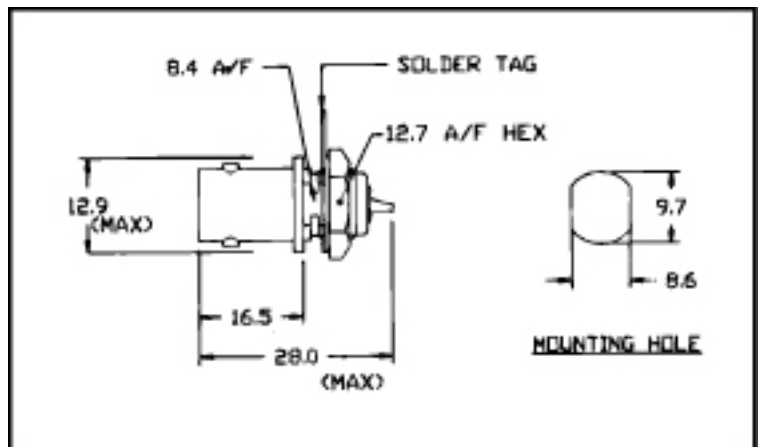

Order Code	Impedance Ohms
SC2 F 04	50

B
N
C



[CONTENTS](#)

[SEARCH](#)

[PREVIOUS](#)

[NEXT](#)

Square Flange Receptacles, Plug

Order Code	Impedance Ohms
SC2 PM 01	50
SC2 PM 02	75

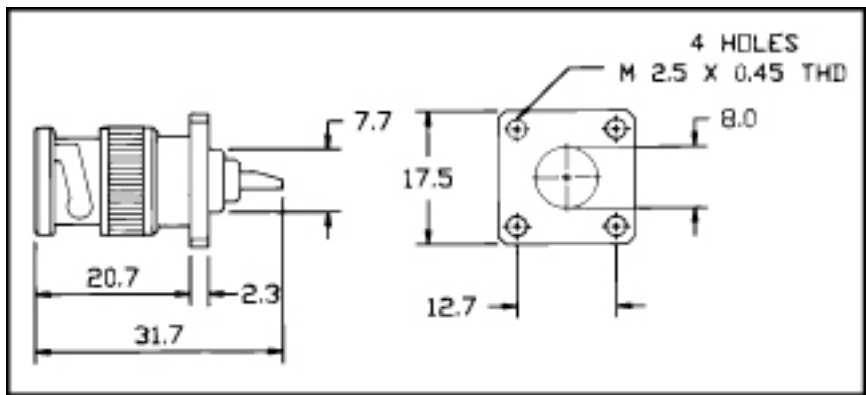

Square Flange Receptacles

Order Code	US-MIL No.	Impedance Ohms
SC2 F 02	UG 290 / U	50
SC2 F 02 - 75		75

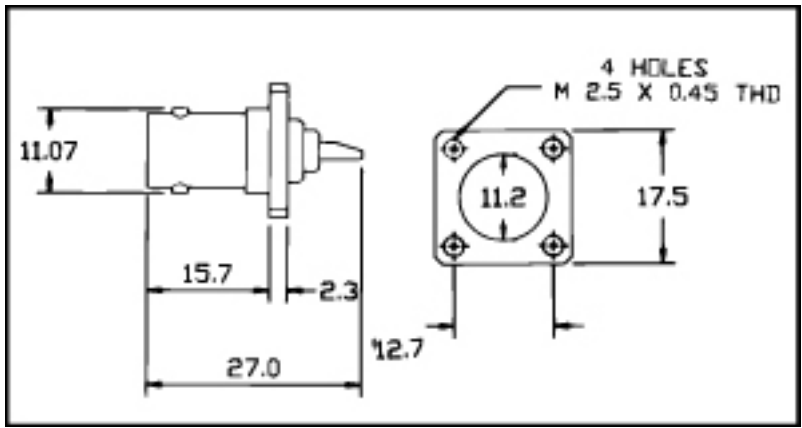

Right Angle Flange Receptacles

Order Code	Impedance Ohms
SC2 FAP 01	50
SC2 FAP 02	75

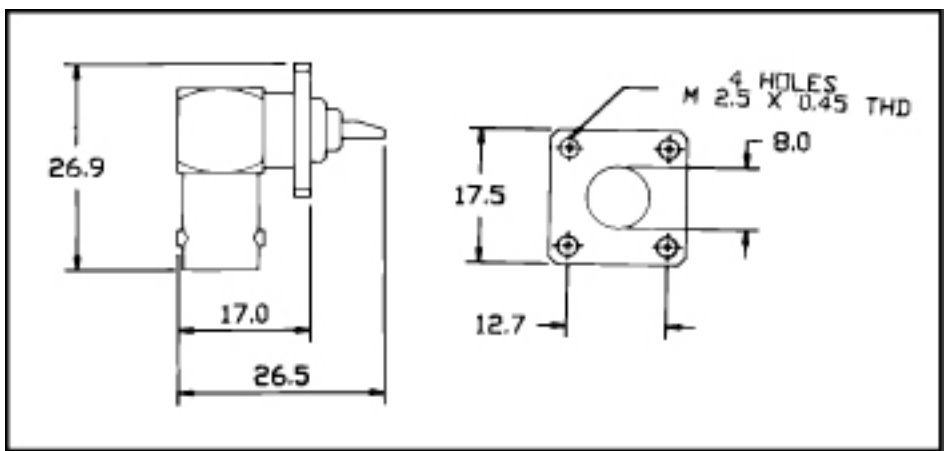

**B
N
C**



CONTENTS

SEARCH

PREVIOUS

NEXT

B
N
C

Right Angle Bulk Head Receptacles

Order Code	Impedance Ohms
SC2 FAB 01	50
SC2 FAB 02	75

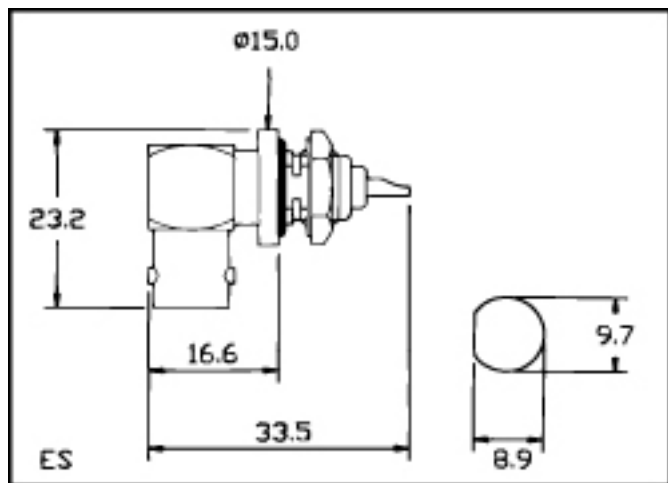

PCB MOUNT RECEPTACLES

Straight PCB Receptacles

Order Code	Impedance Ohms
SC2 F 05	50
SC2 F 15	75

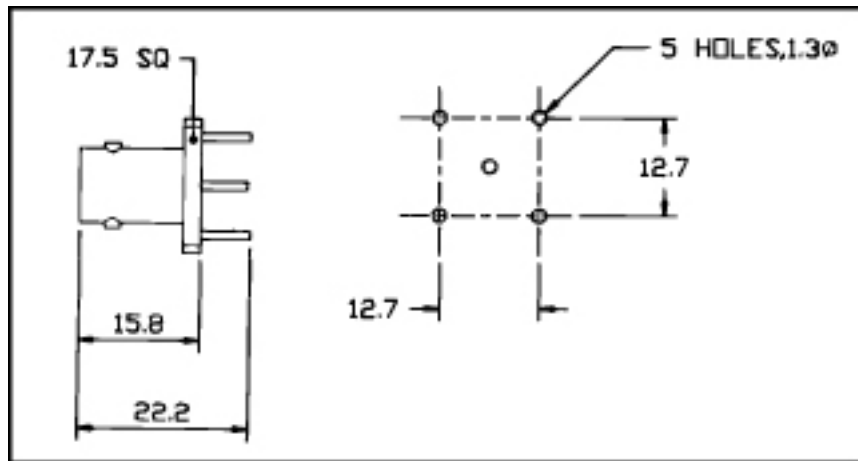

Straight PCB Receptacles

Order Code	Impedance Ohms
SC2 F 05 - W	50
SC2 F 15 - W	75

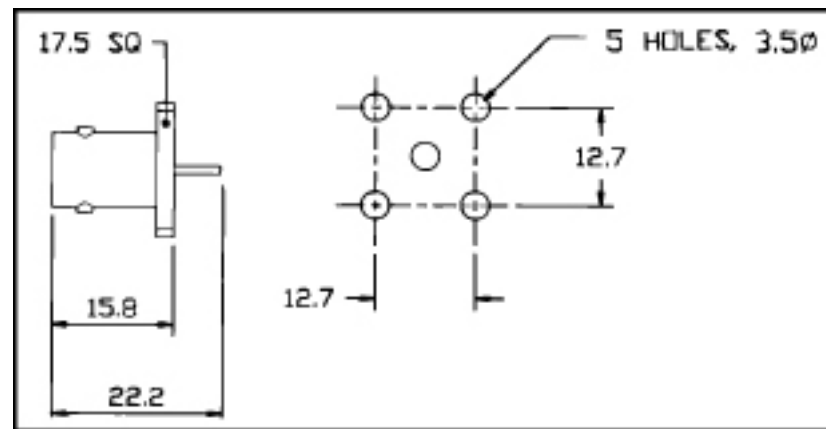



CONTENTS

SEARCH

PREVIOUS

NEXT

Straight PCB Receptacles

Order Code	Impedance Ohms
SC2 F 07	50
SC2 F 17	75

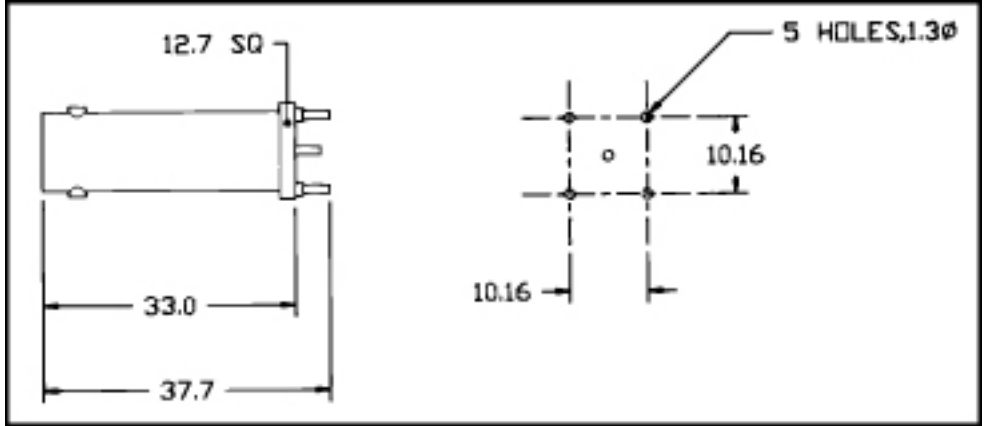

Straight PCB Receptacles

Order Code	Impedance Ohms
SC2 F 09	50
SC2 F 19	75

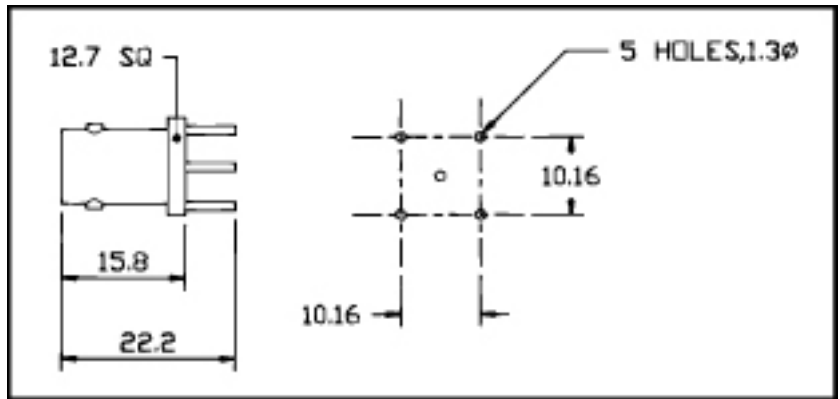

Right Angle PCB Receptacles

Order Code	Impedance Ohms
SC2 FA 07	50
SC2 FA 17	75

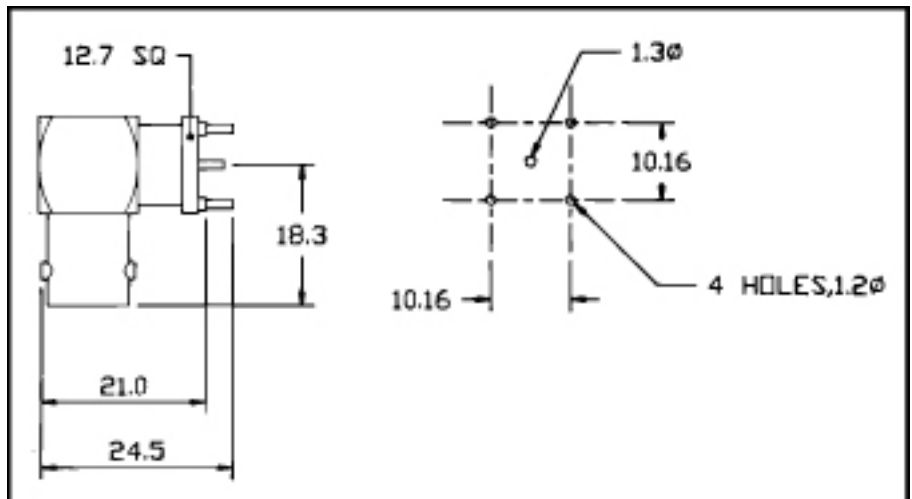

B
N
C



PCB Mount Receptacles

Order Code	Notes
SC2 FA 01	Right Angle
SC2 FA 02	Straight

RIGHT ANGLE

MOUNTING DETAILS

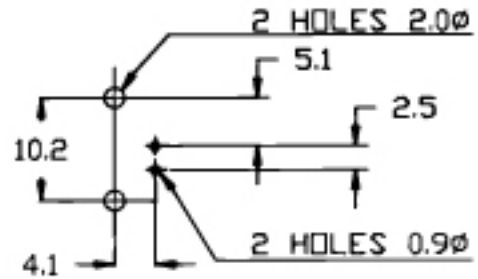
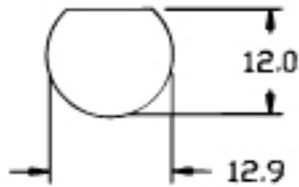
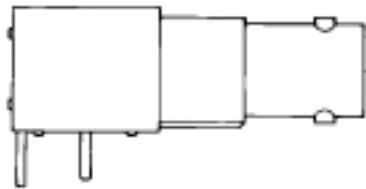

STRAIGHT

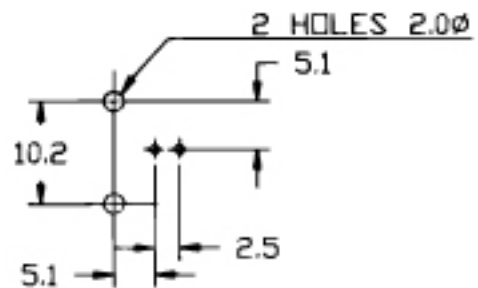
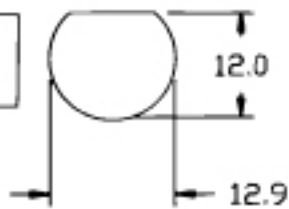
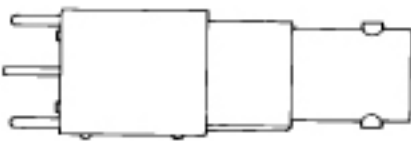

PANEL

PCB DRILLING PATTERN
VIEWED FROM SOLDER SIDE

Working Voltage	500 V AC or DC Peak
Proof Voltage	2 KV DC or AC Peak
Insulation Resistance	> 500 Megohms

Housing	Black Thermoplastic
Body	Brass-Nickel Plated
Contacts	Beryllium Copper-Gold Plated
Insulator	Polypropylene



CONTENTS

SEARCH

PREVIOUS

NEXT

IN SERIES ADAPTORS

Plug-Plug

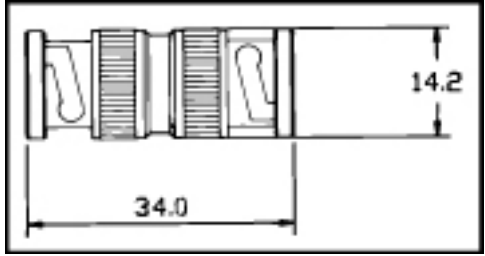

Order Code	US-MIL No.	Impedance Ohms
SC2 MM 01	UG 491 / U	50
SC2 MM 02		75

Jack - Jack

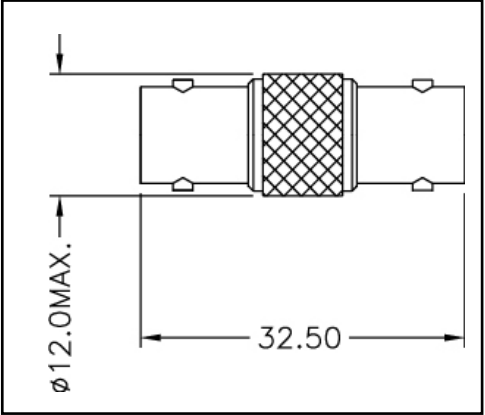

Order Code	Impedance Ohms
SC2 FF 01	50
SC2 FF 02	75

Jack - Jack Bulk Head Mount

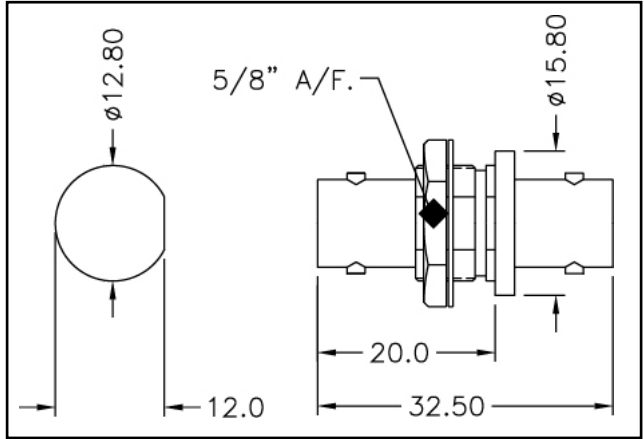

Order Code	Impedance Ohms
SC2 FB 01	50
SC2 FB 02	75

Jack - Jack Bulk Head Mount (with 'O' Ring)

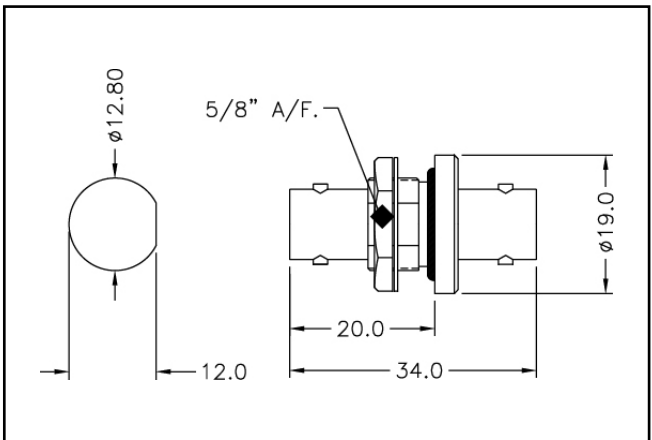

Order Code	Impedance Ohms
SC2 FB 01	50
SC2 FB 02	75

B
N
C



CONTENTS

SEARCH

PREVIOUS

NEXT

**B
N
C**

**Jack - Jack
Flange Mount**

Order Code	US-MIL No.	Impedance Ohms
SC2 FP 01	UG 414 / U	50
SC2 FP 02		75

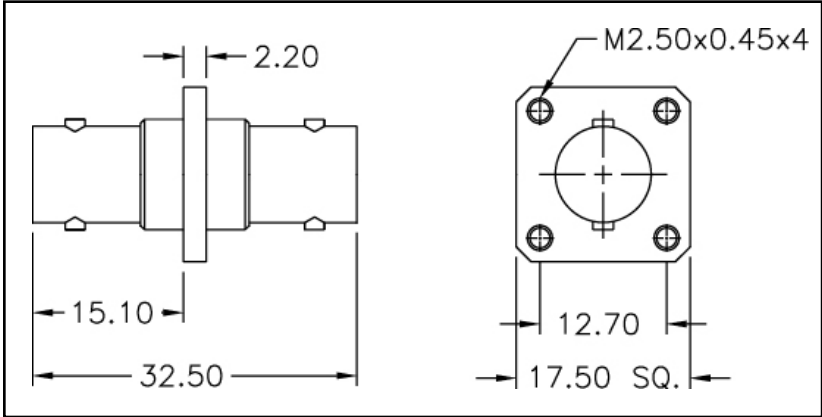

**Right Angle
Plug - Jack**

Order Code	US-MIL No.	Impedance Ohms
SC2 MFA 01	UG 306 / U	50

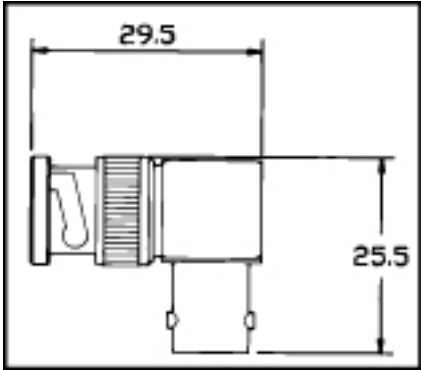

**T Adaptor
Jack - Plug - Jack**

Order Code	US-MIL No.	Impedance Ohms
SC2 T 01	UG 274 / U	50
SC2 T 11		75

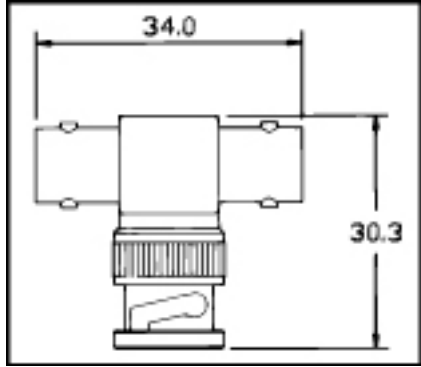

**T Adaptor
Jack - Jack - Jack**

Order Code	Impedance Ohms
SC2 T 02	50
SC2 T 12	75

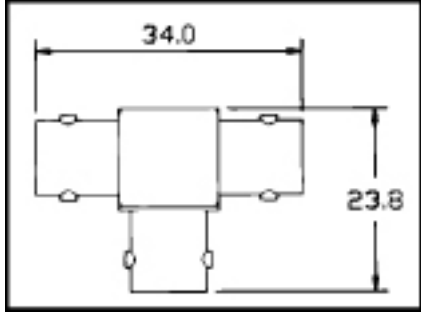

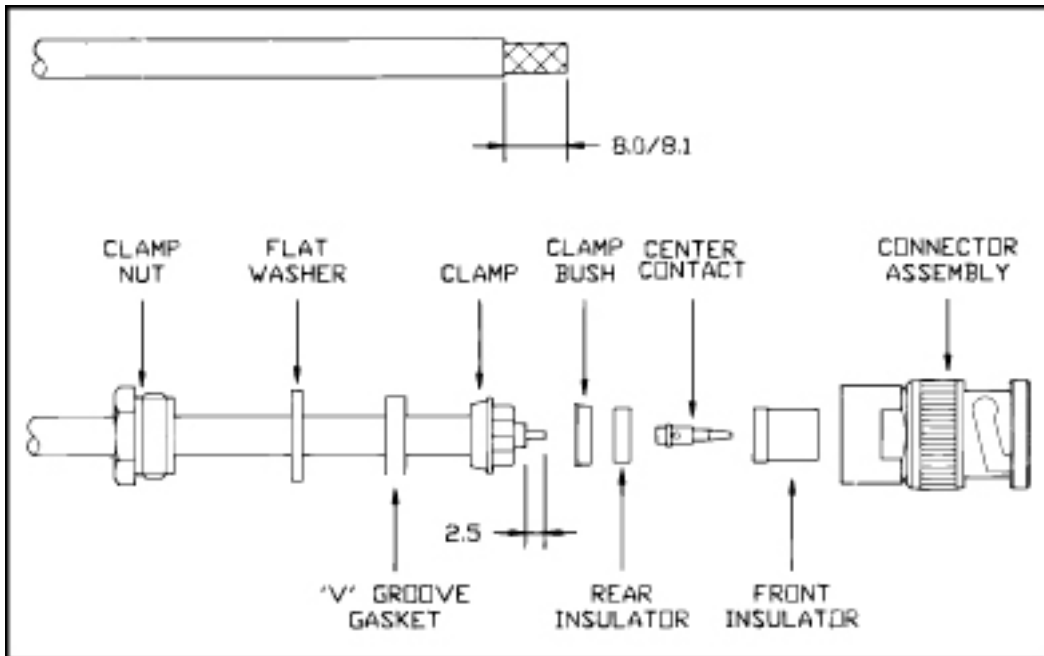
**B 01**

1. Insert the clamp nut, flat washer and 'V' – Groove gasket over cable.
2. Trim the cable as per dimensions shown in the figure and insert clamp over braid so that the inner collar butts against the outer sheath of cable.
3. Comb out the braid and fold them over ferrule as shown in the figure and trim the excess braid.
4. Insert the clamp bush over the dielectric.
5. Fit the rear insulator over the rear end of the centre contact and insert the centre conductor of cable into the centre contact. Solder the centre contact firmly to the cable.
6. Slide the front insulator, 'V' – groove gasket shears and grips the cable firmly.

Note : (i) BNC Plug body is shown, but these instructions apply to both BNC & TNC series.
(ii) A plug body is shown, but these instructions are relevant to both plugs and jacks. The shape of contact and insulators vary.

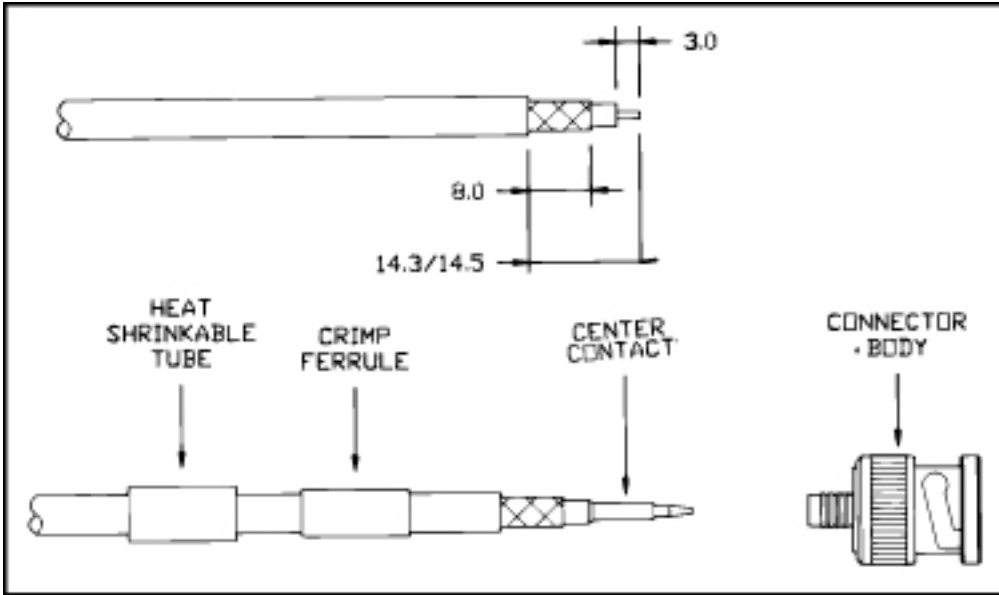

B 02

1. Slide the heat shrinkable tube and the ferrule over cable.
2. Strip the cable as per dimensions shown in figure.
3. Fit the centre contact over the centre conductor of cable and solder the centre contact firmly to the cable.
4. Insert the sub-assembly into body and slide the ferrule until it butts against the body and crimp the ferrule.
5. Shrink the heat shrinkable tube over the ferrule.

Note : (i) BNC Plug body is shown, but these instructions apply to both BNC & TNC series.

(ii) A plug body is shown, but these instructions are relevant to both plugs and jacks. The shape of contacts and insulators vary.

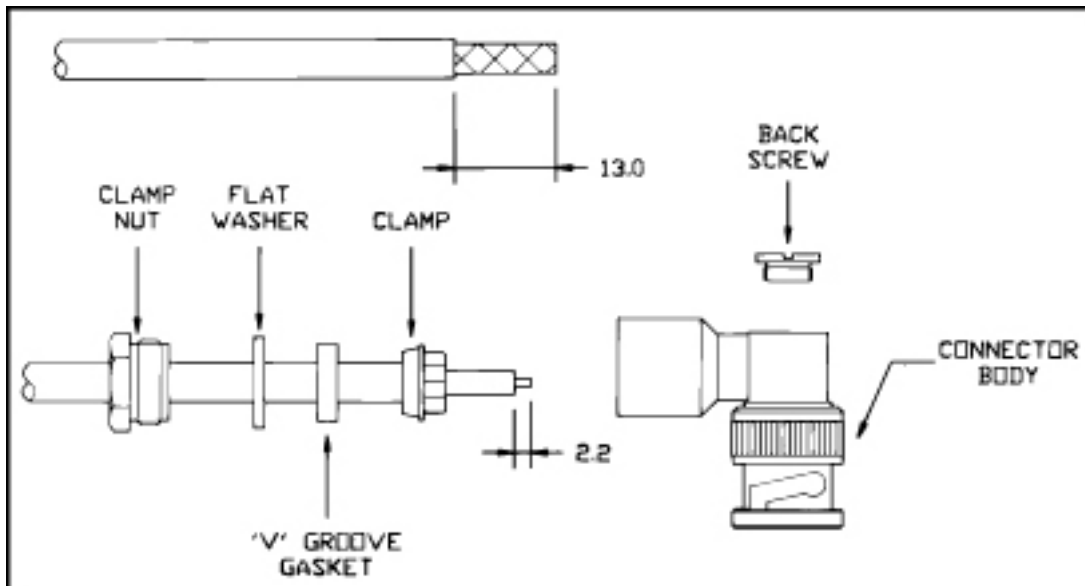

B 03

1. Insert clamp nut, flat washer and 'V' – Groove gasket over cable.
2. Trim the cable as per dimensions shown in the figure and insert clamp over braid so that the inner collar butts against the outer sheath of cable.
3. Comb out the braid and fold them over ferrule as shown in the figure and trim the excess braid.
4. Insert the sub-assembly into the body and solder the centre conductor and centre contact.
5. Tighten the entire assembly with the clamp nut til the 'V' – groove gasket shears and grips the cable firmly.

Note : BNC Plug body is shown, but these instructions apply to both BNC & TNC series.



CONTENTS

SEARCH

PREVIOUS

NEXT

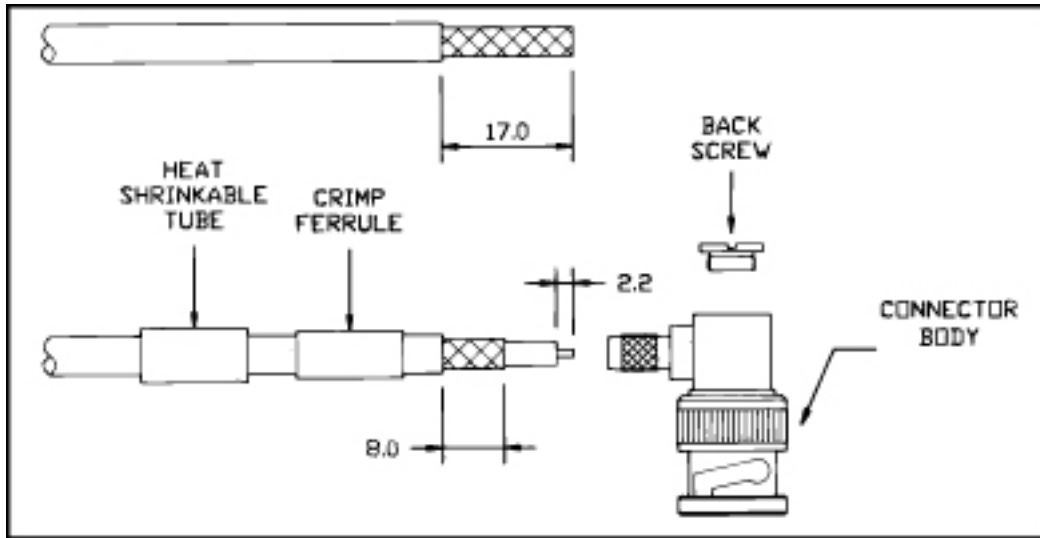

B 04

1. Slide the heat shrinkable tube and the ferrule over cable.
2. Strip the cable as per dimensions shown in figure.
3. Insert the cable into the body. Solder the centre conductor and the centre and the centre contact.
4. Slide the ferrule until it butts against the body and crimp the ferrule.
5. Shrink the heat shrinkable tube over the ferrule.

Note : BNC Plug body is shown, but these instructions apply to both BNC & TNC series.

B
N
C